

# NEXUS

Thomas Dewulf – Mahta Heydari -  
Julina Spinoy - Sriyam Thummatron  
– Julia Torres – Simon Van Oss



Vision

N E U S

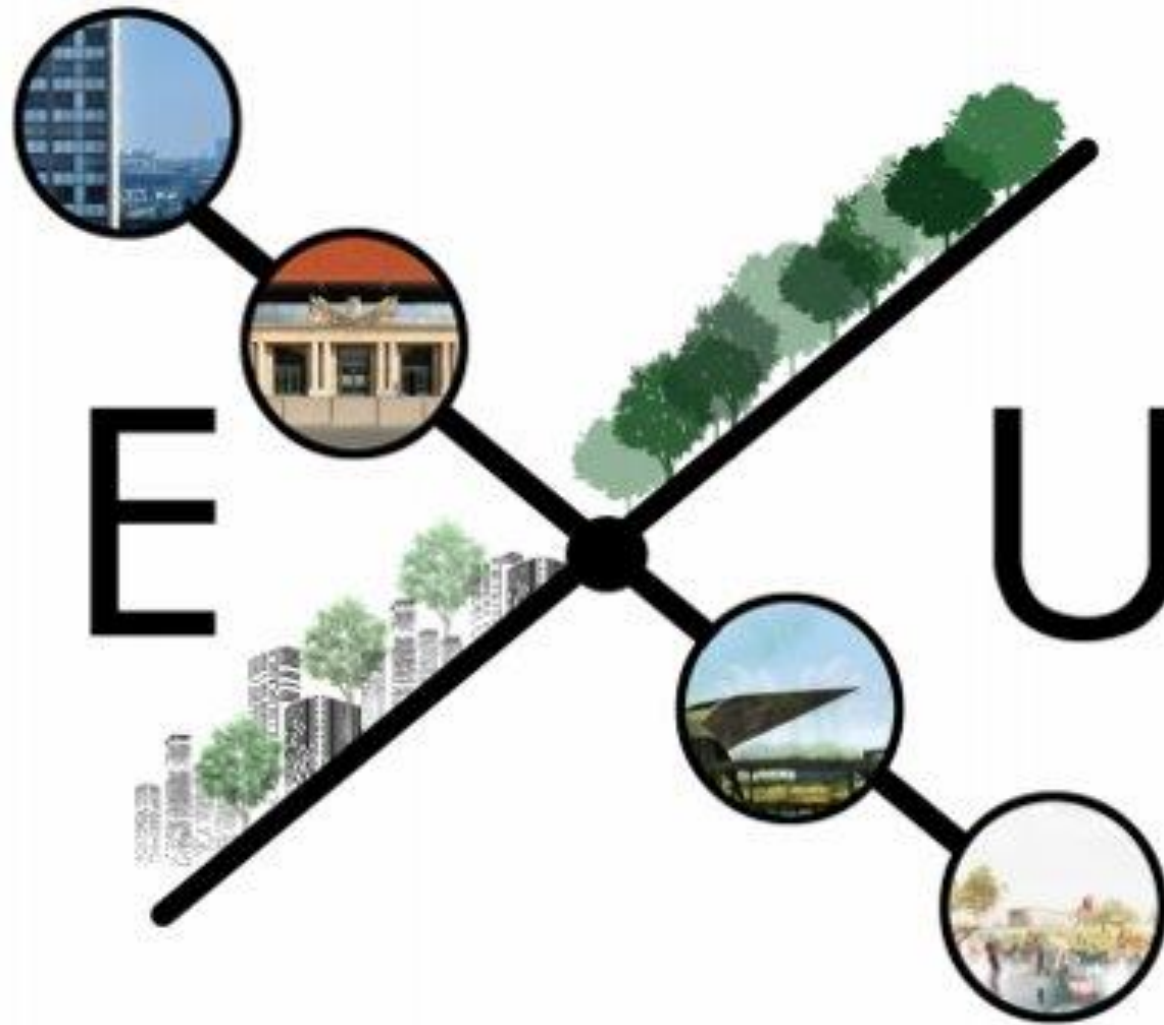

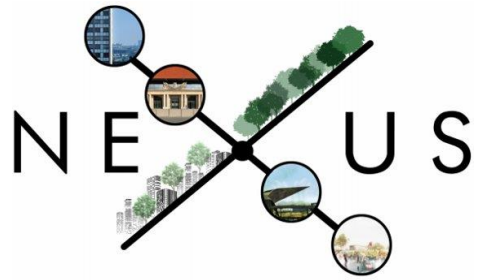

Green East - West  
connection



Renovated stadium de-  
termines the spatial  
structure

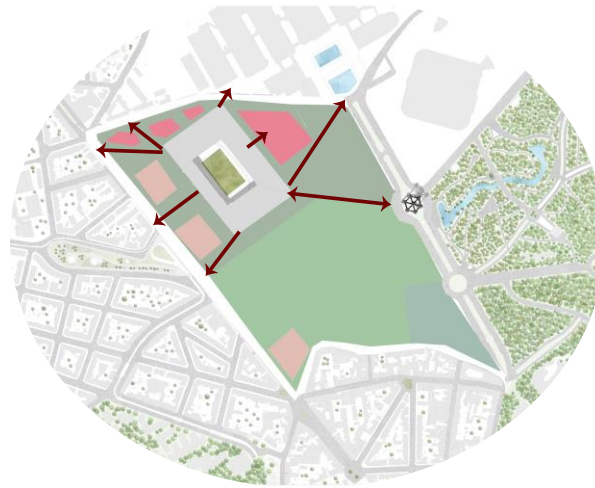

Pedestrian / bike oriented

- Public Space
- Sportspark
- High density building
- Building block
- Bike Highways



# Spatial Concept

Masterplan

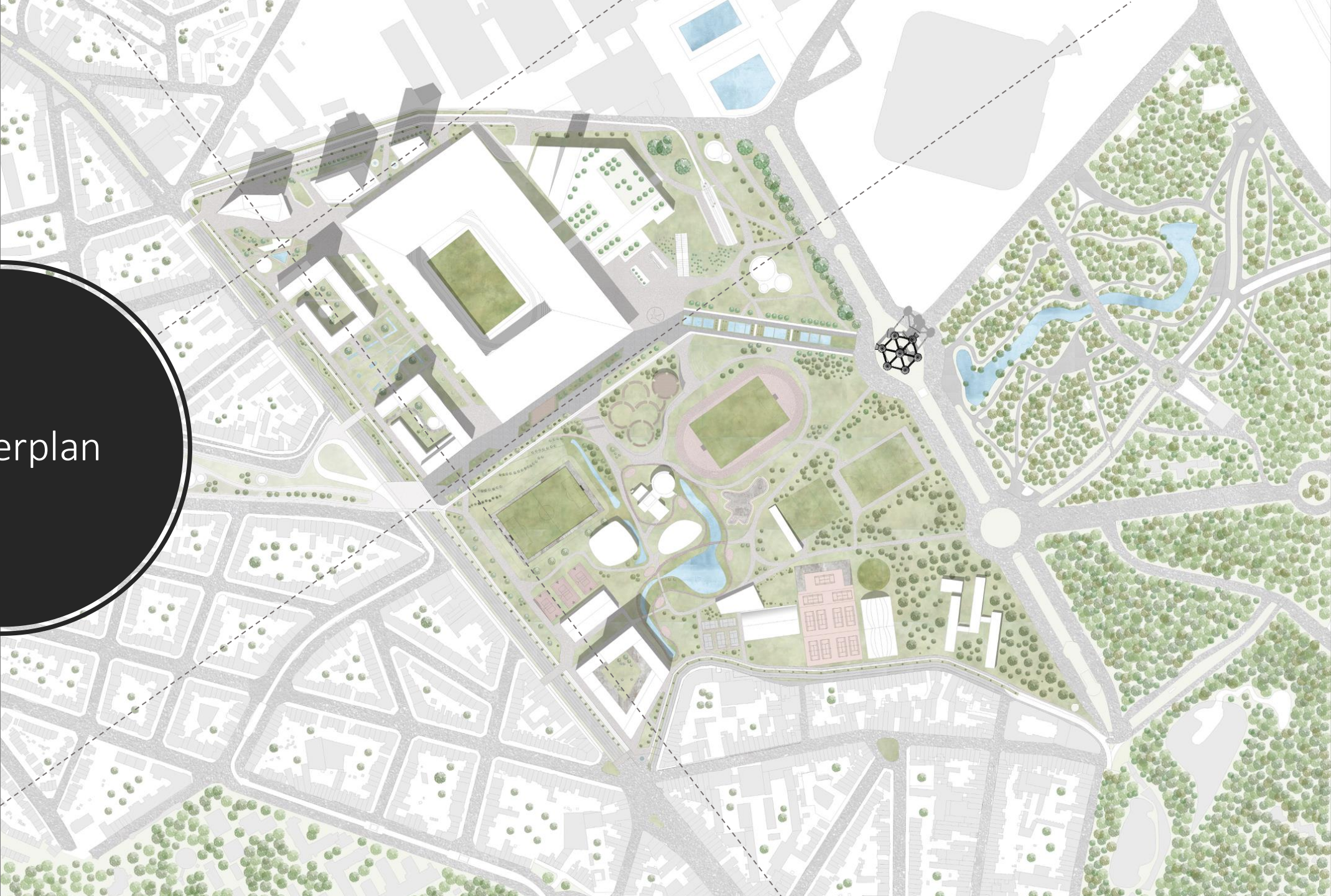

Sections

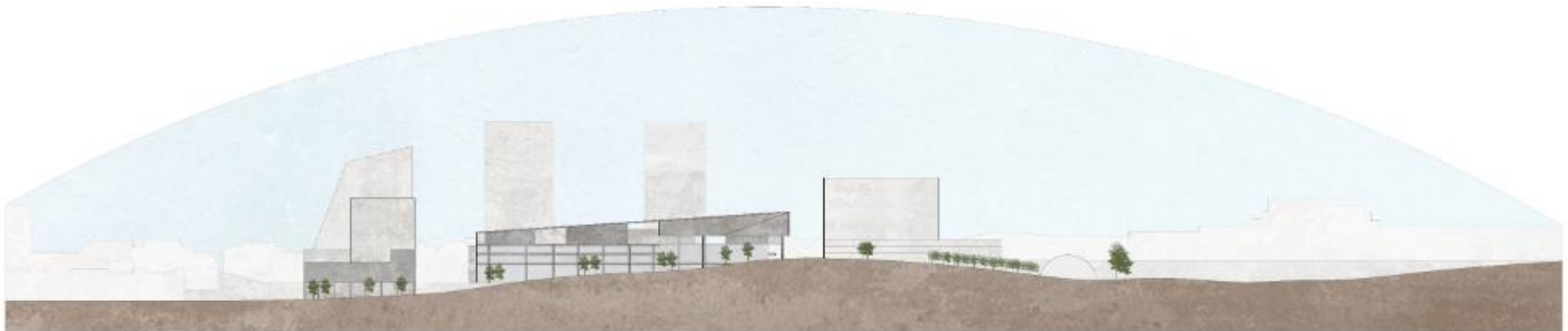
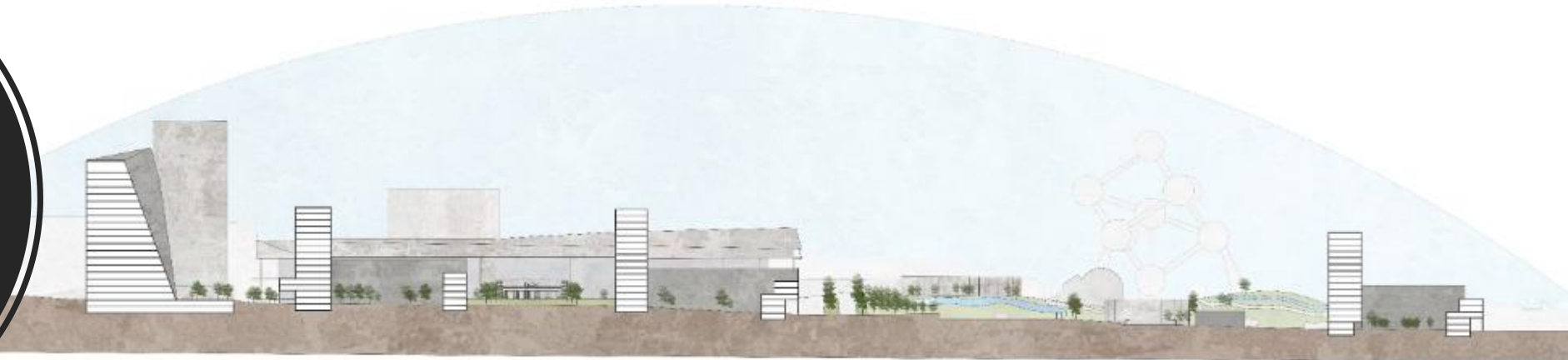



Global View



# Stadium

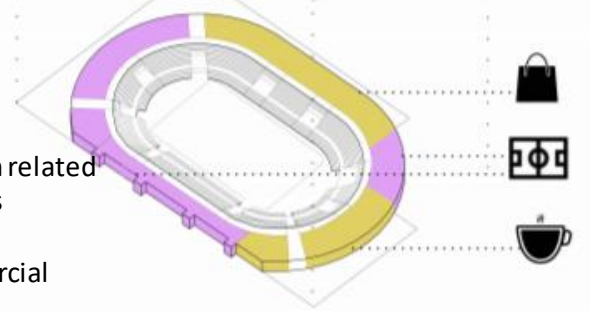
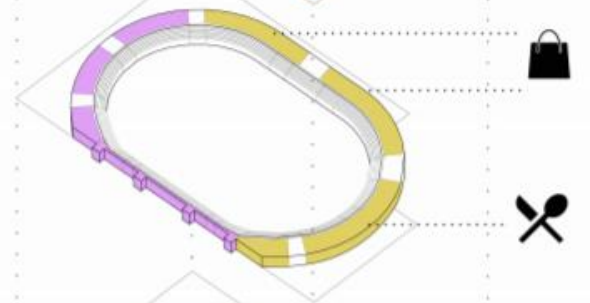
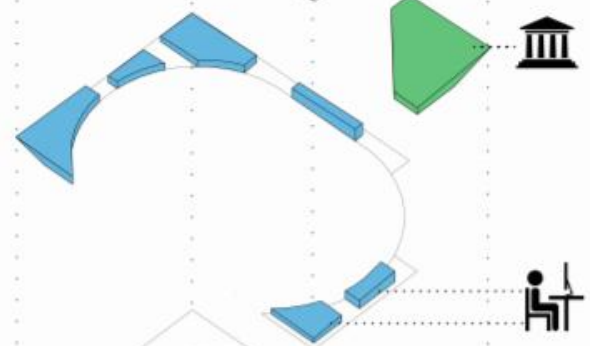
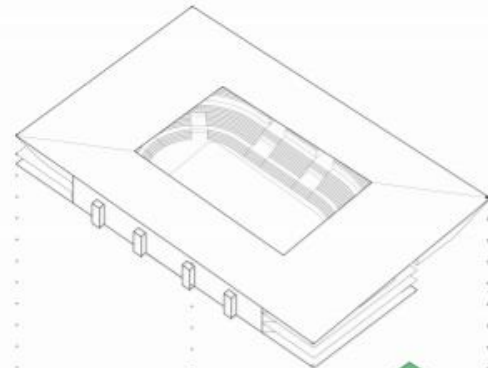
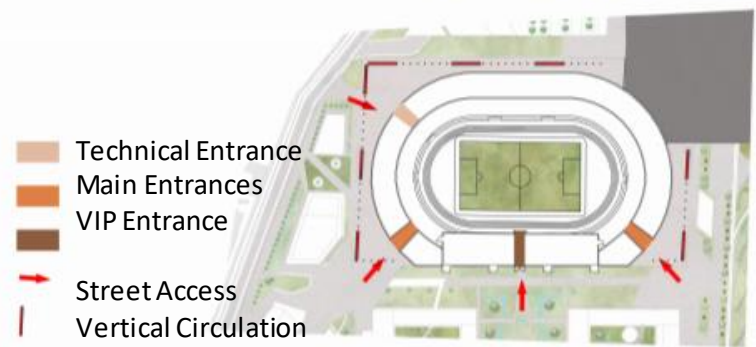
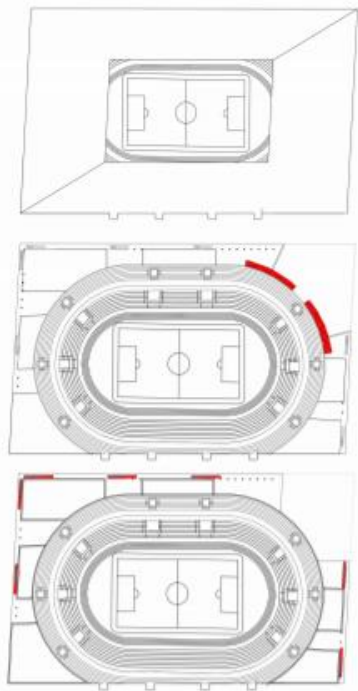

- Stadium related
- Services
- Offices
- Commercial





Stadium

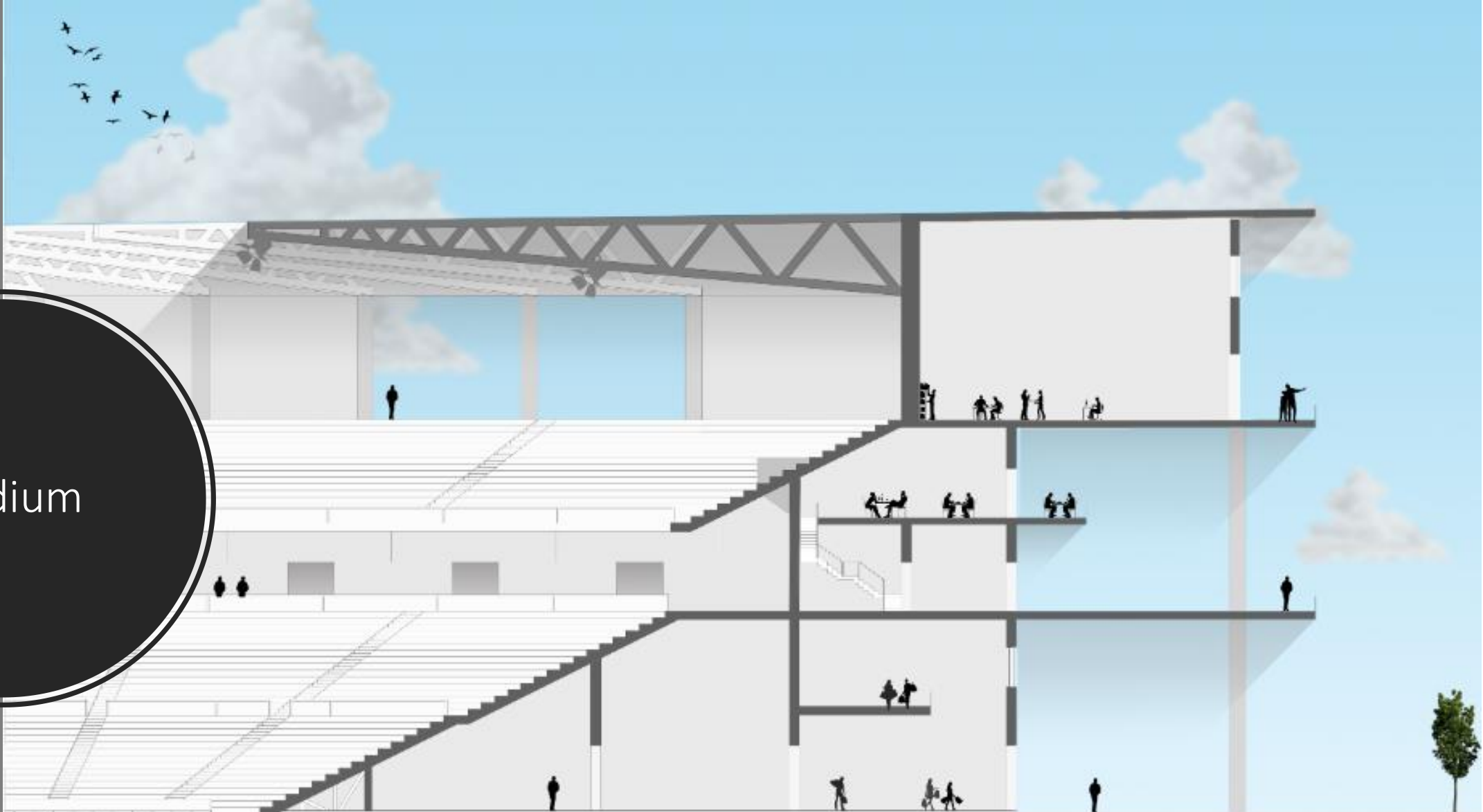

Stadium



# Sustainable Strategies

## Blue and Green network

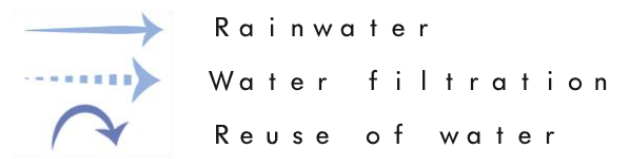

## Water filtration

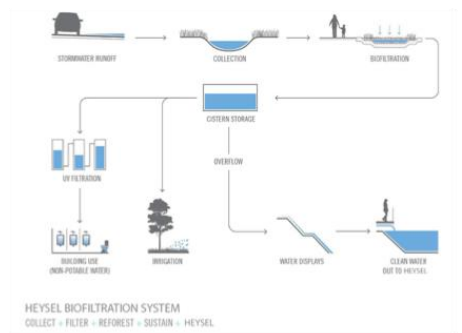

## Boulevard Section

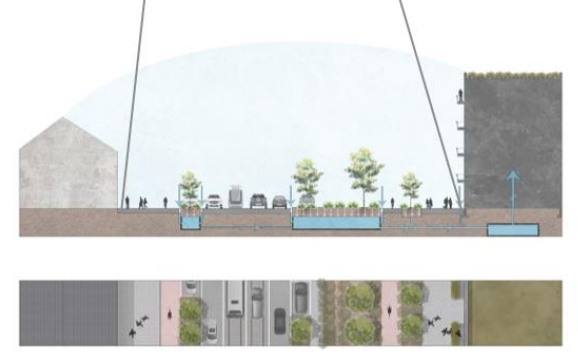

# Sustainable Strategies

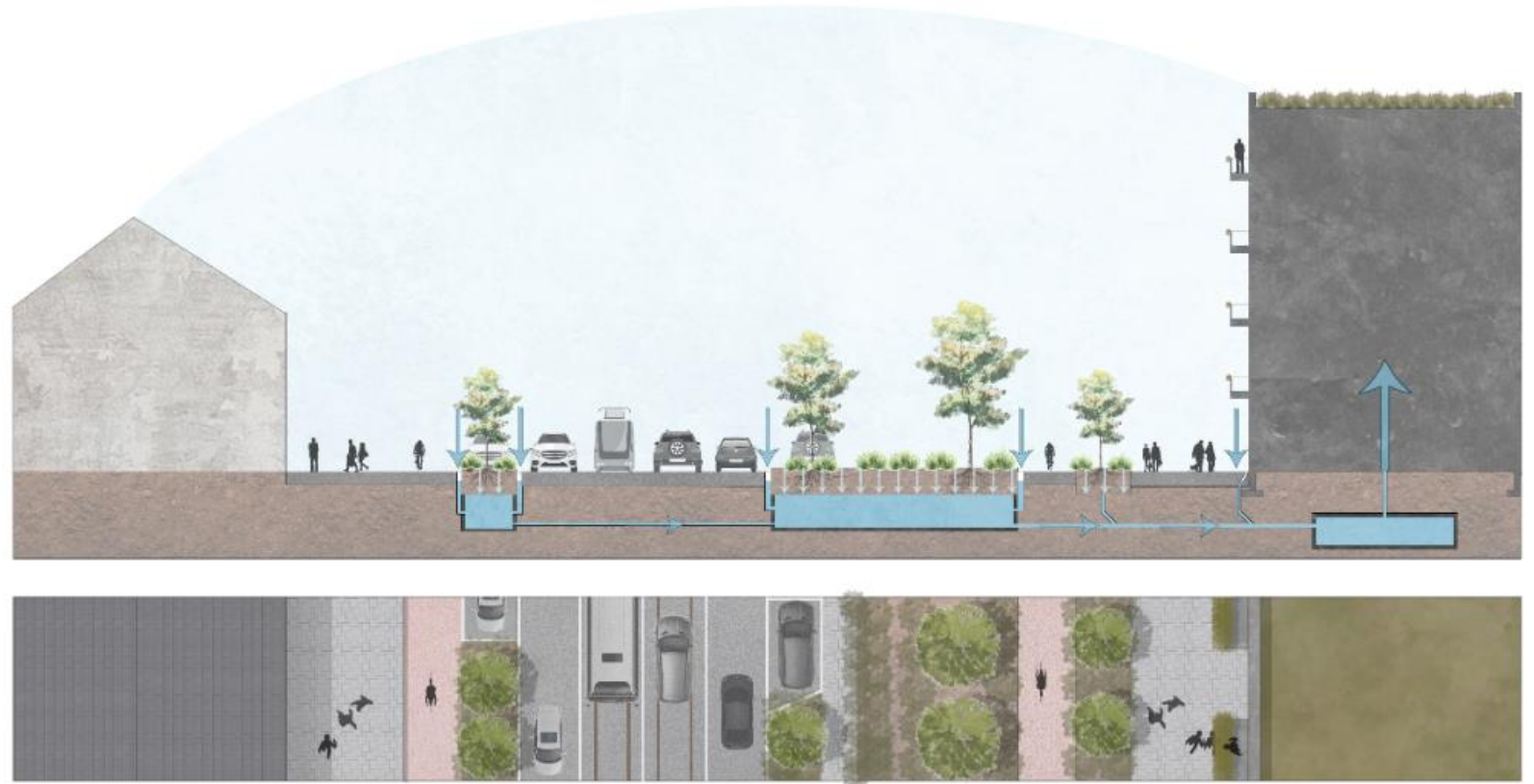

# Sustainable Strategies

## Green houses

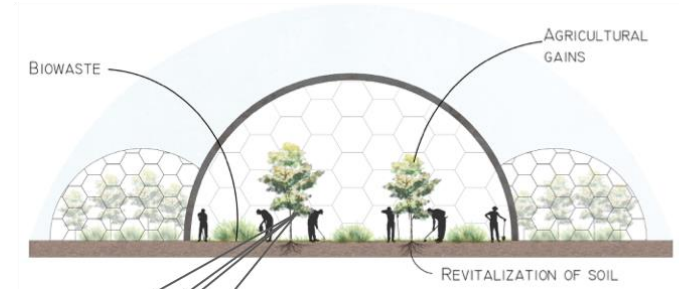

## Solar / Green roof



Solar Panels for the daily-use functions

The green roofs are private or semi-private

The green houses represent expositional agriculture to revitalize the polluted soil

# Atmospheres



An architectural rendering of a modern building with a paved walkway and people at sunset. The building features a grid of windows and a prominent walkway. People are walking on the path, and there are trees and streetlights. The sky is a mix of orange and purple, suggesting sunset or sunrise. A large black circle with a white border is overlaid on the left side of the image, containing the word "Atmospheres".

# Atmospheres